

QUARTZ FITTING SUPER 300 TYPE

Super 300 Type Quartz Fittings

The Pillar Quartz fitting combines patented S300 fitting – a leak free, high temperature, high pressure resistance fitting for PFA tubing - and a unique ferrule design with the security of a stopper ring for the quartz side, all in one compact body.



Features

- Increased performance and safety**
 The PFA stopper ring locks security into the quartz groove. The latest S300 fitting design generates greater holding force, which means a safe and secure PFA tube connection.
- Excellent chemical resistance**
 The wetted parts are made from PTFE and PFA, providing excellent corrosion resistance.
- Ultra clean manufacturing process**
 Pillar fittings are processed in a Class 1000 clean room, from resin to finished product. They are packed in the Pillar “Clean Pack”, to maintain the highest purity until the fitting is needed.

Design Feature

MAX OPERATING TEMP.	200°C
MAX OPERATING PRESSURE	0.4MPa

For liquid use only

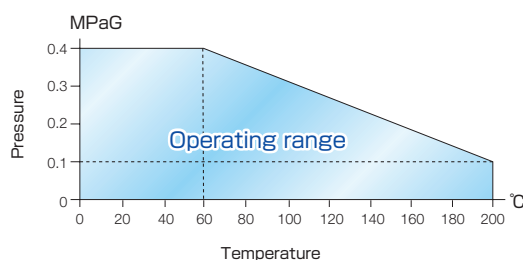

Quartz tube dimension

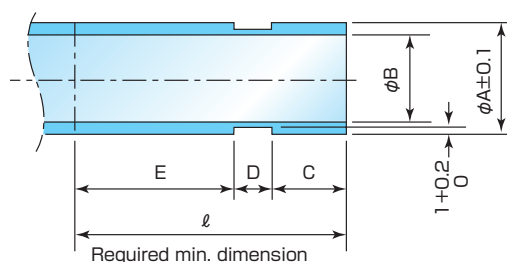

QUARTZ TUBE	±0.1 φA	φB	C	D	E	ℓ
φ8×φ4	8	4	6	4	17	27
φ10×φ6	10	6	9	4.5	19.5	33
φ12×φ8	12	8	11	5	23	39
φ16×φ12	16	12	13	6	26	45
φ19×φ15	19	15	13.5	6.5	28	48
φ20×φ16	20	16	13.5	6.5	28	48
φ25×φ20	25	20	23	8	35	66

※ Quartz tube need groove as listed above.
PILLAR do not supply the Quartz tubing.

Configuration

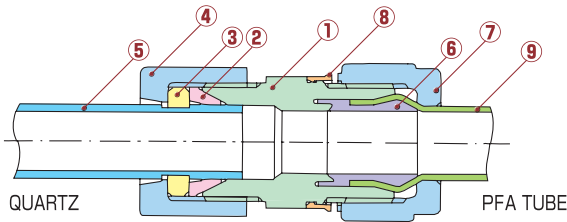

No.	PART	MATERIAL	No.	PART	MATERIAL
①	BODY	PTFE	⑥	SLEEVE	P F A
②	FERRULE	PTFE	⑦	UNION NUT	P F A
③	STOPPER RING	P F A	⑧	GAUGE RING	ETFE
④	UNION NUT	P F A	⑨	PFA TUBE	P F A
⑤	QUARTZ TUBE	QUARTZ			

How to order

Q - R U 8 - P 8 A								
TYPE	SHAPE	QUARTZ TUBE OD	SUPER 300 FITTING	TUBE SIZE	BODY MATERIAL A=PTFE B=PFA			
PFA TUBE								
		mm		inch				
O.D × I.D	THICK-NESS	TOLERANCE		O.D × I.D	THICK-NESS	TOLERANCE		
		O.D	WALL THICKNESS			O.D	WALL THICKNESS	
6×4	1.0	±0.10	±0.06	6.35×3.95	W2	1.2	±0.10	
8×6					9.53×6.33	W3	1.6	±0.12 ±0.10
10×8		±0.12			12.7×9.5	W4		
12×10					19×15.8	W6		
19×15.8	1.6	±0.20	±0.10	25.4×22.2	W8		±0.20	
25×22	1.5							

Assembling Please refer to the operation manual

● Insertion of quartz tube

PILLAR QUARTZ-FITTING is composed of, stopper ring, body, ferrule and union nut.

Installation method is

- (1) Run the quartz tube through the union nut.
- (2) Put the stopper ring into the groove of quartz tube.
- (3) Insert the ferrule taking care of the correct direction.
- (4) Union nut should be hand turned strongly and turned half turn by spanner. (Don't turn over)

● Insertion of PFA tube

Super 300 Type PILLAR Fitting is composed of sleeve, union nut and gauge ring.

Installation method is

- (1) Run the tube through union nut.
- (2) Insert the sleeve to tube.
- (3) Tighten until the projection of the gauge ring and the projection at the end of the union nut come into contact with each other.

Q-RU

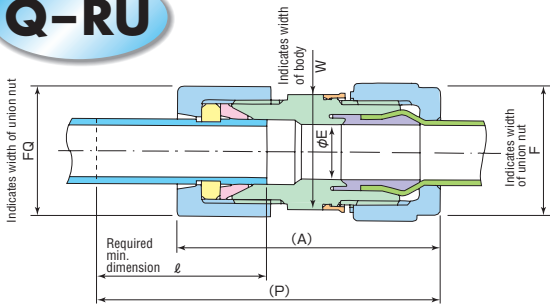

PART No.	Quartz tube	PFA TUBE		(P)	ℓ	FQ	F	(A)	W	φE	
Q-RU	O.D	I.D	O.D	I.D							
8-P8B	8	4	8	6	64	27	17	19	50.7	18	6
10-P10A	10	6	10	8	71.5	33	22	23	56.7	21	8
10-PW3A	10	6	9.53	6.33	71.5	33	22	23	56.7	21	8
12-P12A	12	8	6	4	71.8	39	27	16	53.9	23	4
12-PW2A	12	8	6.35	3.95	71.8	39	27	16	53.9	23	4
12-P12A	12	8	12	10	81.8	39	27	28	63.9	25	10
12-PW4A	12	8	12.7	9.5	81.8	39	27	28	63.9	25	10
16-P8A	16	12	8	6	82	45	32	19	61	28	6
16-P12A	16	12	12	10	89	45	32	28	68	28	10
16-PW4A	16	12	12.7	9.5	89	45	32	28	68	28	10
19-P19A	19	15	19	15.8	100	48	38	38	78	33.5	16
20-P19B	20	16	19	15.8	100	48	38	38	78	34	16
20-PW6B	20	16	19	15.8	100	48	38	38	78	34	16
25-P25B	25	20	25	22	128.3	66	50	47.5	100.3	44	22
25-PW8B	25	20	25.4	22.2	128.3	66	50	47.5	100.3	44	22

Q-RUE

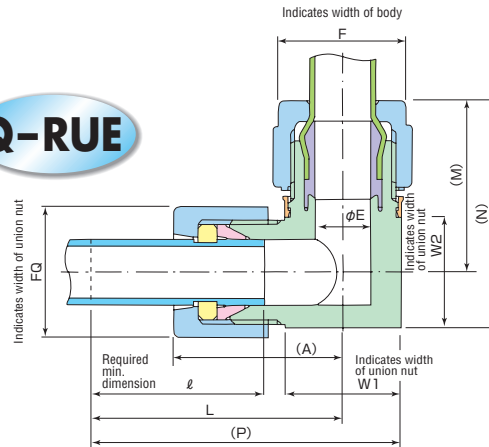

PART No.	Quartz tube	PFA TUBE		(P)	ℓ	FQ	F	L	(M)	(N)	(A)	W1	W2	φE
Q-RUE	O.D	I.D	O.D	I.D										
8-P6A	8	4	6	4	50	27	17	16	42.5	26.5	34	29.2	15	4
8-PW2A	8	4	6.35	3.95	50	27	17	16	42.5	26.5	34	29.2	15	4
8-P8A	8	4	8	6	53	27	17	19	44	29.5	37	30.7	18	6
10-P10A	10	6	10	8	60.5	33	22	23	50	34.5	44	35.2	21	8
10-PW3A	10	6	9.53	6.33	60.5	33	22	23	50	34.5	44	35.2	21	8
12-P12A	12	8	12	10	70.8	39	27	28	58.3	40.5	52	40.4	25	10
12-PW4A	12	8	12.7	9.5	70.8	39	27	28	58.3	40.5	52	40.4	25	10
16-P12A	16	12	12	10	78	45	32	28	65.5	43	57	44.5	25	28
16-PW4A	16	12	12.7	9.5	78	45	32	28	65.5	43	57	44.5	25	28
19-P19A	19	15	19	15.8	87.6	48	38	38	70.8	52	68	48.8	33.5	32
20-P19B	20	16	19	15.8	86.1	48	38	38	72.6	57.1	68.1	50.6	27	27
20-PW6B	20	16	19	15.8	86.1	48	38	38	72.6	57.1	68.1	50.6	27	27
25-P25B	25	20	25	22	113.3	66	50	47.5	91.8	65	87	63.8	43	44
25-PW8B	25	20	25.4	22.2	113.3	66	50	47.5	91.8	65	87	63.8	43	44

NIPPON PILLAR PACKING CO., LTD

Head Office : 11-48, Nonakaminami 2 Chome, Yodogawa-ku, Osaka, 532-0022 Japan.
Tel : 81-(0)6-6305-2821 Fax : 81-(0)6-6302-3300
E-mail : info@pillar.co.jp

Nippon Pillar Corporation of America : 1562, Parkway Loop, Suite 2C, Tustin, CA 92780, USA.
Tel : 1-714-258-7741 Fax : 1-714-258-7760
E-mail : sales@nipponpillar.com

Nippon Pillar Singapore Pte, Ltd. : No. 237 Pandan Loop, #03-01 Westech Building, Singapore 128424
Tel : (65)6861-7138 Fax : (65)6862-9098
E-mail : npillars@singnet.com.sg

Taiwan Pillar Industry Co., Ltd. : 8F, No.45, SEC.1, MINQUAN E. RD., ZHONGSHAN DIST., TAIPEI CITY., 10452, TAIWAN.
Tel : TAIPEI(886) 2-2587-1911 Fax : TAIPEI(886) 2-2585-3131
URL: http://www.taiwanpillar.com.tw/ E-mail: sales@taiwanpillar.com.tw

Shanghai Pillar Trading Co., Ltd. : Far East International Plaza A-1111, No.319, Xianxia Road, Changning District, Shanghai China. (200051)
Tel : CHINA(86) 21-6208-7711 Fax : CHINA(86) 21-6235-0501
URL: http://www.pillar-cn.com/ E-mail: sales@sh.pillar-cn.com

Nippon Pillar Packing Co., Ltd. India Liaison Office : 111(old no.46) 4th Main Road, Gandhi Nagar, Adayar, Chennai 600 020, India
Tel : +91-44-3299-1422

http://www.pillar.co.jp/ e-mail : info@pillar.co.jp

*Specifications and dimensions are subject to change without prior notice.

*The data on this catalogue are solely for your reference and are not to be construed as constituting a warranty.



Follow the instructions, before installation and operation, for your safety.