

SPELA 300 PILLAR BELLOWS PUMP PS SERIES

PTFE Bellows Pump with No pulsation.

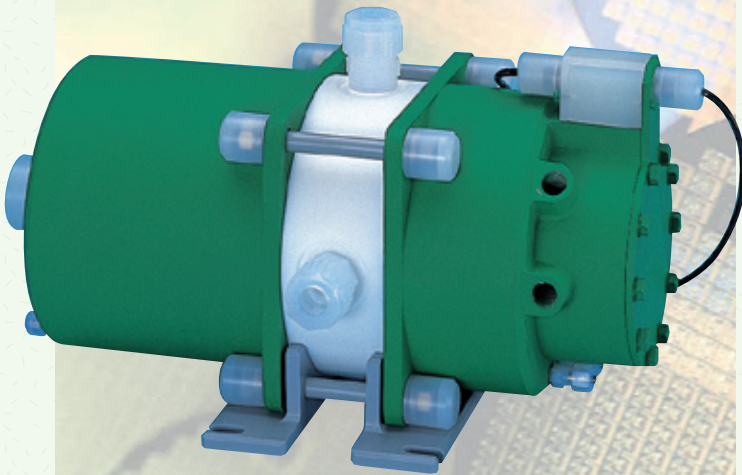

**PS-10MA
20MA
40MA**

Features

- 1 Low pulsation pressure (pulsation pressure rate within $\pm 12.5\%$)
- 2 Space saving design. (2/3 volume of the current model)
- 3 VA design reduces the costs.

PS- 10MA, PS- 20MA, PS- 40MA

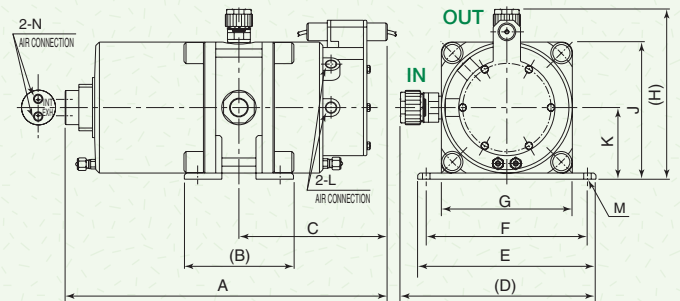

DIMENSIONS (mm)

	A	B	C	(D)		E	F	G	(H)		J	K	L	M	N
				SUPER 300 FITTING	SUPER FITTING				SUPER 300 FITTING	SUPER FITTING					
PS-10MA	435	99	210	233	236	218	193	148	197	198	157	83	Rc1/4"	4-M8	Rc1/4"
PS-20MA	480	121	226	289	291	261	236.4	192	251	254	201	105	Rc3/8"	4-M10	Rc1/4"
PS-40MA	544	164	266	389	—	335	300	255	326	328	264	136.5	Rc1/2"	4-M12	Rc1/4"

Type	PS- 10MA			PS- 20MA			PS- 40MA					
Pump connections mm (inch)	IN $\phi 19$ / OUT $\phi 12$ (IN $\phi 3/4$ " / OUT $\phi 1/2$ ")			IN $\phi 25$ / OUT $\phi 19$ (IN $\phi 1$ " / OUT $\phi 3/4$ ")			IN $\phi 38.1$ / OUT $\phi 25.4$ (IN $\phi 1 1/2$ " / OUT $\phi 1$ ")					
Pump connectors	SUPER 300 TYPE PILLARFITTING or SUPER TYPE PILLARFITTING											
Max discharge capacity ℓ /min (GPM)	12 (3.17)			24 (6.34)			48 (12.7)					
Pulsation pressure range	Within $\pm 12.5\%$ of the pump discharge pressure when the pressure is over 0.1MPaG. Less than 0.03MPaG when pump discharge pressure is under 0.1MPaG.											
Operating temp. $^{\circ}\text{C}$ ($^{\circ}\text{F}$)	10~40 (50~104)	41~70 (105~158)	71~100 (160~212)	10~40 (50~104)	41~70 (105~158)	71~100 (160~212)	10~40 (50~104)	41~70 (105~158)	71~100 (160~212)			
Supply air pressure MPaG (PSIG)	0.2~0.5 (29.0~72.6)	0.2~0.4 (29.0~58.0)	0.2~0.3 (29.0~43.5)	0.2~0.5 (29.0~72.6)	0.2~0.4 (29.0~58.0)	0.2~0.3 (29.0~43.5)	0.2~0.5 (29.0~72.6)	0.2~0.4 (29.0~58.0)	0.2~0.3 (29.0~43.5)			
Max discharge pressure MPaG (PSIG)	0.45 (65.3)	0.35 (50.8)	0.25 (36.3)	0.45 (65.3)	0.35 (50.8)	0.25 (36.3)	0.45 (65.3)	0.35 (50.8)	0.25 (36.3)			
Allowable differential Pressure of Bellows MPa (PSIG)	0.3 (43.5)	0.25 (36.3)	0.2 (29.0)	0.3 (43.5)	0.25 (36.3)	0.2 (29.0)	0.3 (43.5)	0.25 (36.3)	0.2 (29.0)			
Discharge capacity per stroke ℓ /stroke (IN ³) [※ 1]	0.11 (6.71)			0.22 (13.43)			0.48 (29.30)					
Air consumption ℓ /min [Normal] (SCFM)	50~150 (1.8~5.3)			80~270 (2.8~9.5)			100~420 (3.5~15)					
Ambient temperature $^{\circ}\text{C}$ ($^{\circ}\text{F}$)	10~50 (50~122)											
Air inlet ports (inch)	For pump operation			2-Rc 1/4" (2-NPT 1/4")			2-Rc 3/8" (2-NPT 3/8")			2-Rc 1/2" (2-NPT 1/2")		
	For master valve			2-Rc 1/4" (2-NPT 1/4")			2-Rc 1/4" (2-NPT 1/4")			2-Rc 1/4" (2-NPT 1/4")		
Weight kg (lb)	10 (22)			22 (44)			40 (88)					
Pump size mm (inch) [※2]	435L × 218W × 157H (16.8L × 8.6W × 6.2H)			480L × 261W × 201H (18.6L × 10.3W × 7.9H)			544L × 335W × 264H (21.1L × 13.2W × 10.4H)					

- Different size of pump connections may vary the above figure.
- Specify type of end connection when ordering.
- We have also explosionproof pumps that are suitable for pumping an explosive organic solution.
- The length of the suction pipe does not exceed 2m.
- We have also PC series pumps for CMP slurry, please contact us.

[※ 1] The value applies when the standard stroke is selected. Be sure to run the pump at a pumping speed of 100spm or lower.
[※ 2] The reference value of the pump size(cast metal size) is designed under the JIS standard tolerance.

Performance Curves for PS-10MA

Performance Curves for PS-10MA (at 20°C)

PIPING SIZE FOR AIR: $\phi 6 \times \phi 4 \times 2M$ PIPING SIZE FOR FLUID: IN $\phi 19 \times \phi 15.8 \times 2M$ OUT $\phi 12 \times \phi 10$ FLUID: PURE WATER

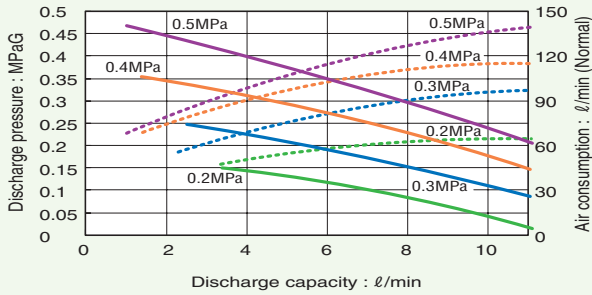

Performance Curves for PS-10MA (at 80°C)

PIPING SIZE FOR AIR: $\phi 6 \times \phi 4 \times 2M$ PIPING SIZE FOR FLUID: IN $\phi 19 \times \phi 15.8 \times 2M$ OUT $\phi 12 \times \phi 10$ FLUID: PURE WATER

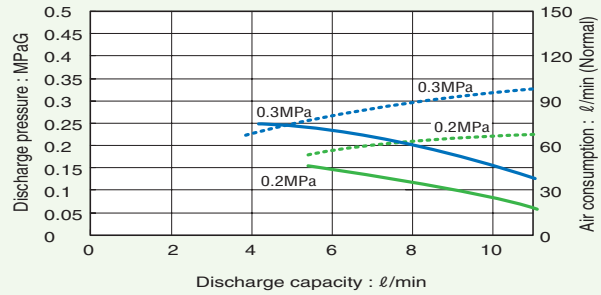

Performance Curves for PS-20MA

Performance Curves for PS-20MA (at 20°C)

PIPING SIZE FOR AIR: $\phi 8 \times \phi 6 \times 2M$ PIPING SIZE FOR FLUID: IN $\phi 25 \times \phi 22 \times 2M$ OUT $\phi 19 \times \phi 15.8$ FLUID: PURE WATER

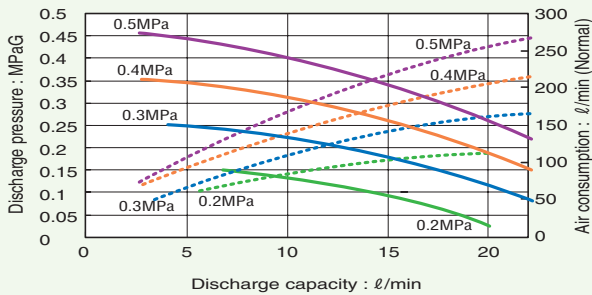

Performance Curves for PS-20MA (at 80°C)

PIPING SIZE FOR AIR: $\phi 8 \times \phi 6 \times 2M$ PIPING SIZE FOR FLUID: IN $\phi 25 \times \phi 22 \times 2M$ OUT $\phi 19 \times \phi 15.8$ FLUID: PURE WATER

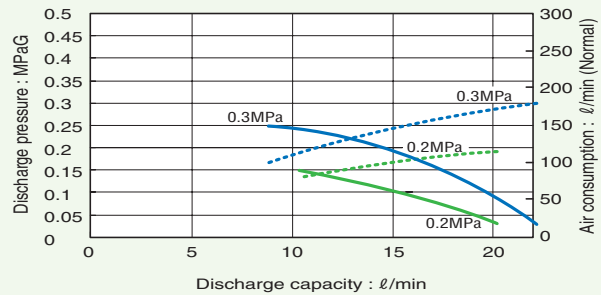

Performance Curves for PS-40MA

Performance Curves for PS-40MA (at 20°C)

PIPING SIZE FOR AIR: $\phi 12 \times \phi 10 \times 2M$ PIPING SIZE FOR FLUID: IN JIS 10K 32A OUT $\phi 25 \times \phi 22$ FLUID: PURE WATER

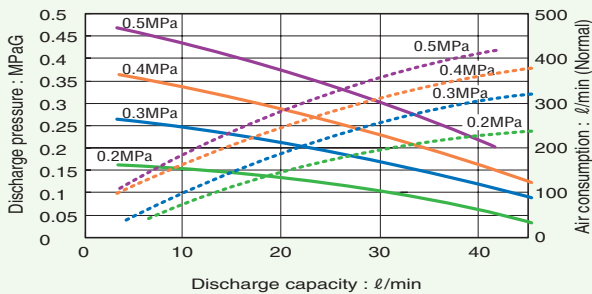

Performance Curves for PS-40MA (at 80°C)

PIPING SIZE FOR AIR: $\phi 12 \times \phi 10 \times 2M$ PIPING SIZE FOR FLUID: IN JIS 10K 32A OUT $\phi 25 \times \phi 22$ FLUID: PURE WATER

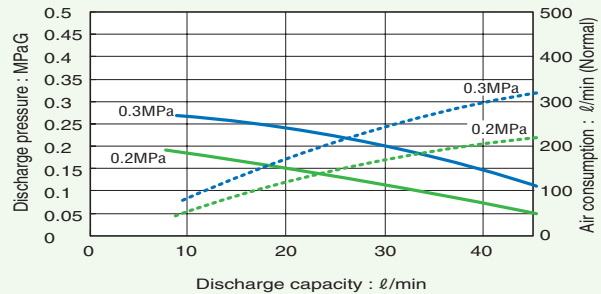

NIPPON PILLAR PACKING CO., LTD.

Head Office : 11-48, Nonakaminami 2 Chome, Yodogawa-ku, Osaka, 532-0022 Japan.
Tel : 81-(0)6-6305-2821 Fax : 81-(0)6-6302-3300
E-mail : info@pillar.co.jp

Nippon Pillar Corporation of America : 1562, Parkway Loop, Suite2C, Tustin, CA 92780, USA.
Tel : 1-714-258-7741 Fax : 1-714-258-7760
E-mail : sales@nipponpillar.com

Nippon Pillar Singapore Pte, Ltd. : No. 237 Pandan Loop, #03-01 Westech Building, Singapore 128424
Tel : (65)6861-7138 Fax : (65)6862-9098
E-mail : npillars@singnet.com.sg

Taiwan Pillar Industry Co.,Ltd. : 8F, No.45, SEC.1, MINQUAN E. RD., ZHONGSHAN DIST, TAIPEI CITY, 10452, TAIWAN.
Tel : TAIPEI(886) 2-2587-1911 Fax : TAIPEI(886) 2-2585-3131
URL: http://www.taiwanpillar.com.tw/ E-mail: sales@taiwanpillar.com.tw

Shanghai Pillar Trading Co.,Ltd. : Far East International Plaza A-1111, No.319, Xianxia Road, Changning District, Shanghai China. (200051)
Tel : CHINA(86) 21-6208-7711 Fax : CHINA(86) 21-6235-0501
URL: http://www.pillar-cn.com/ E-mail: sales@sh.pillar-cn.com

Nippon Pillar Packing Co.,Ltd. India Liaison Office : 111(old no.46),4th Main Road, Gandhi Nagar, Adayar, Chennai 600 020, India
Tel : +91-44-3299-1422

<http://www.pillar.co.jp/> e-mail : info@pillar.co.jp

*Specifications and dimensions are subject to change without prior notice.

*The data on this catalogue are solely for your reference and are not to be construed as constituting a warranty.



CAUTION

• Follow the instructions, before installation and operation, for your safety.